

Five Current School Streets

Becontree Primary School

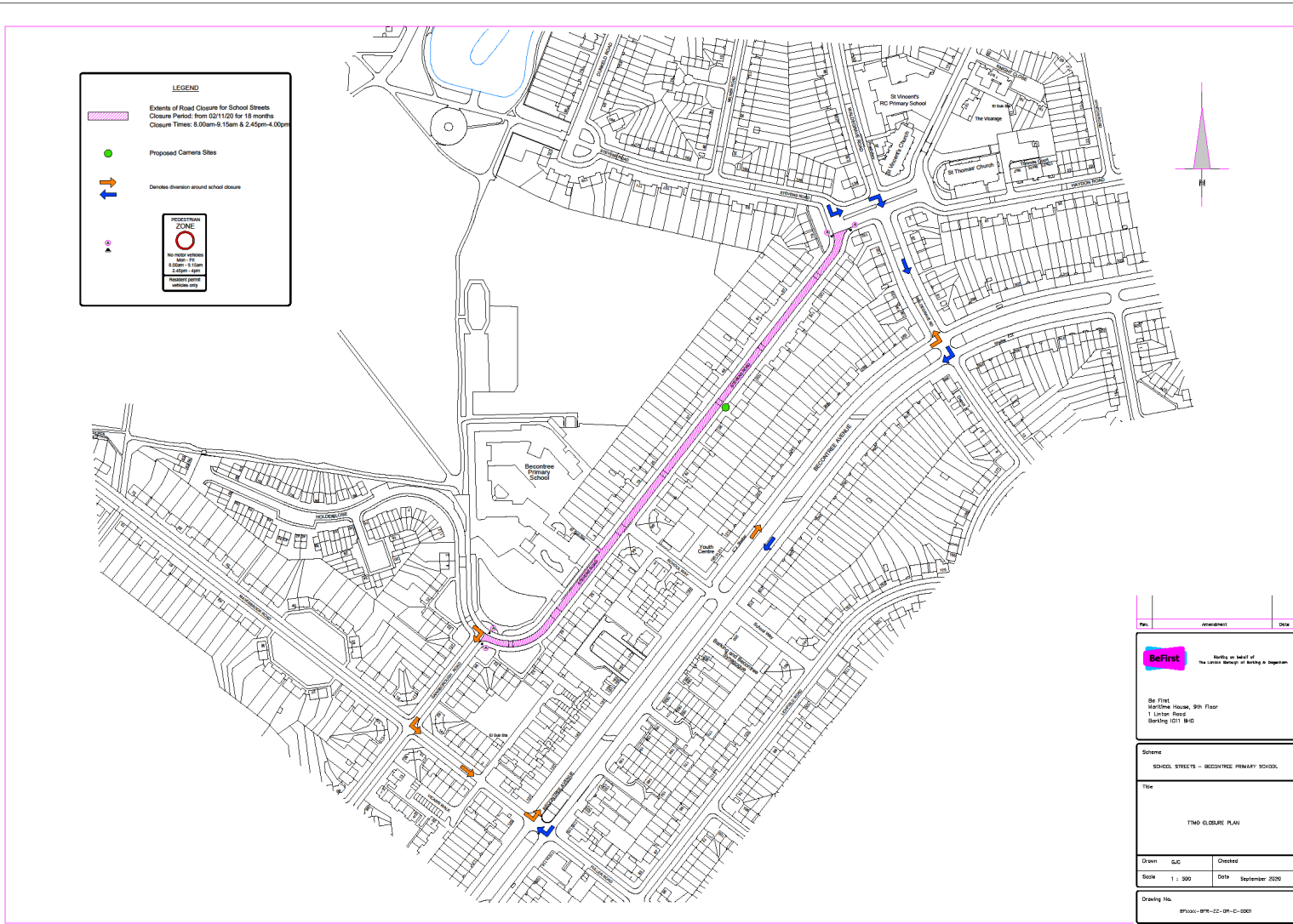

Dorothy Barley Primary School

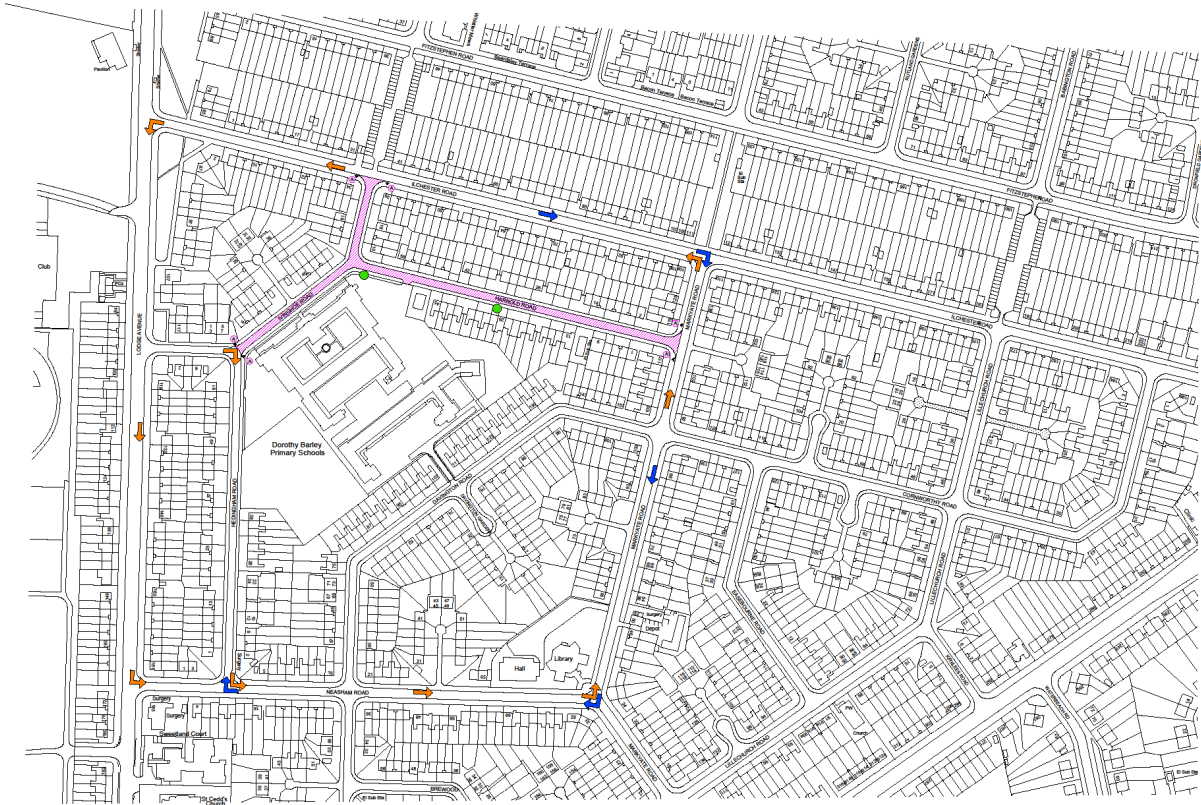

LEGEND

- Extent of Road Closure for School Streets
Closure Period: from 02/11/20 for 18 months
Closure Times: 8.00am-9.15am & 2.45pm-4.00pm
- Proposed Camera Sites
- Diverted diversion around school closure

PEDESTRIAN ZONE

NO MOTOR VEHICLES
8.00am - 11.00am
2.45pm - 4.00pm
Pedestrians
vehicles only

Rev.	Amendment	Date
<small>Be First is part of the Local Safety of Working & Learning</small>		
Be First Werthe House, 9th Floor 1 Linton Road Barking IG11 8HG		
Scheme SCHOOL STREETS - DOROTHY BARLEY PRIMARY SCHOOL		
Title TMO CLOSURE PLAN		
Drawn	SJC	Created
Scale	1 : 500	Date
		September 2020
Drawing No. BFOU-BP-22-08-C-0001		

Eastbury Primary School

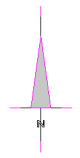
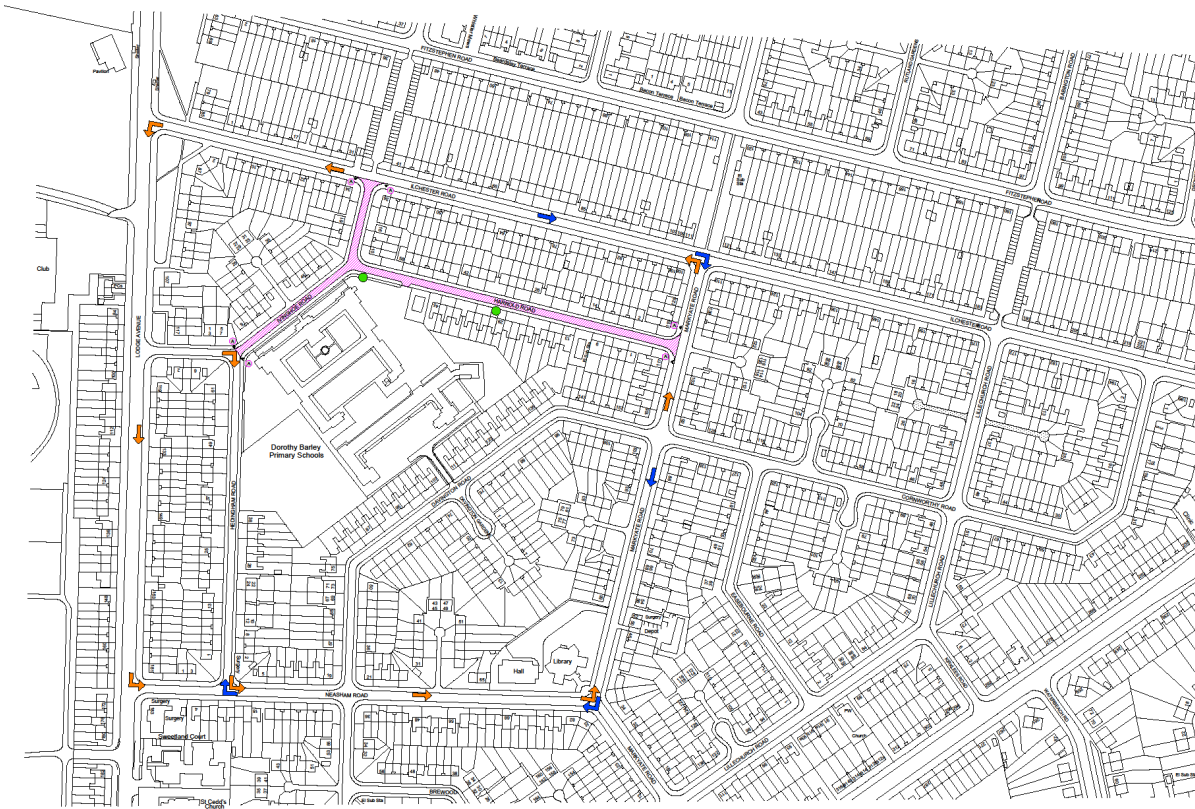

LEGEND

- Extent of Road Closures for School Streets
- Closure Period: from 02/11/20 for 18 months
- Closure Times: 8.00am-9.15am & 2.45pm-4.00pm
- Proposed Camera Sites
- Diversions around school closure

RESTRICTION ZONE

No motor vehicles
8.00am - 9.15am
& 2.45pm - 4.00pm

Motorcycles
Excluded

Trucks only

No.	Amendment	Date
BeFirst on behalf of The London Borough of Barking & Dagenham		
Be First Maritime House, 9th Floor 1 Licken Road Barking (D11 8JG)		
Scheme SCHOOLS STREETS - DOROTHY BARLEY PRIMARY SCHOOL		
Title TRNG CLOSURE PLAN		
Drawn	SJC	Checked
Scale	1 : 500	Date
September 2023		
Drawing No. BPR001-BP-22-06-C-001		

Grafton Primary School

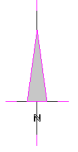

LEGEND

- Extent of Road Closure for School Streets
Closure Period: from 02/1/20 for 18 months
Closure Times: 8.00am-9.15am & 2.45pm-4.00pm
- Proposed Camera Sites
- Direction around school closure

PROXIMATE ZONE:

No motor vehicles
8.00am - 9.15am
2.45pm - 4.00pm
Pedestrian zone
Vehicle only

File: [redacted] | Amendment: [redacted] | Date: [redacted]

BeFirst Partners in the heart of the London Borough of Waltham Forest

Be First
Maritime House, 9th Floor
1 Linton Road
Barking IG11 9JG

Scheme
SCHOOL STREETS - GRAFTON PRIMARY SCHOOL

Title
TWO CLOSURE PLAN

Drawn	SJC	Checked	
Scale	1 : 500	Date	September 2020

Drawing No. WFC020-1819-22-02-01-D-0001

Manor Junior School

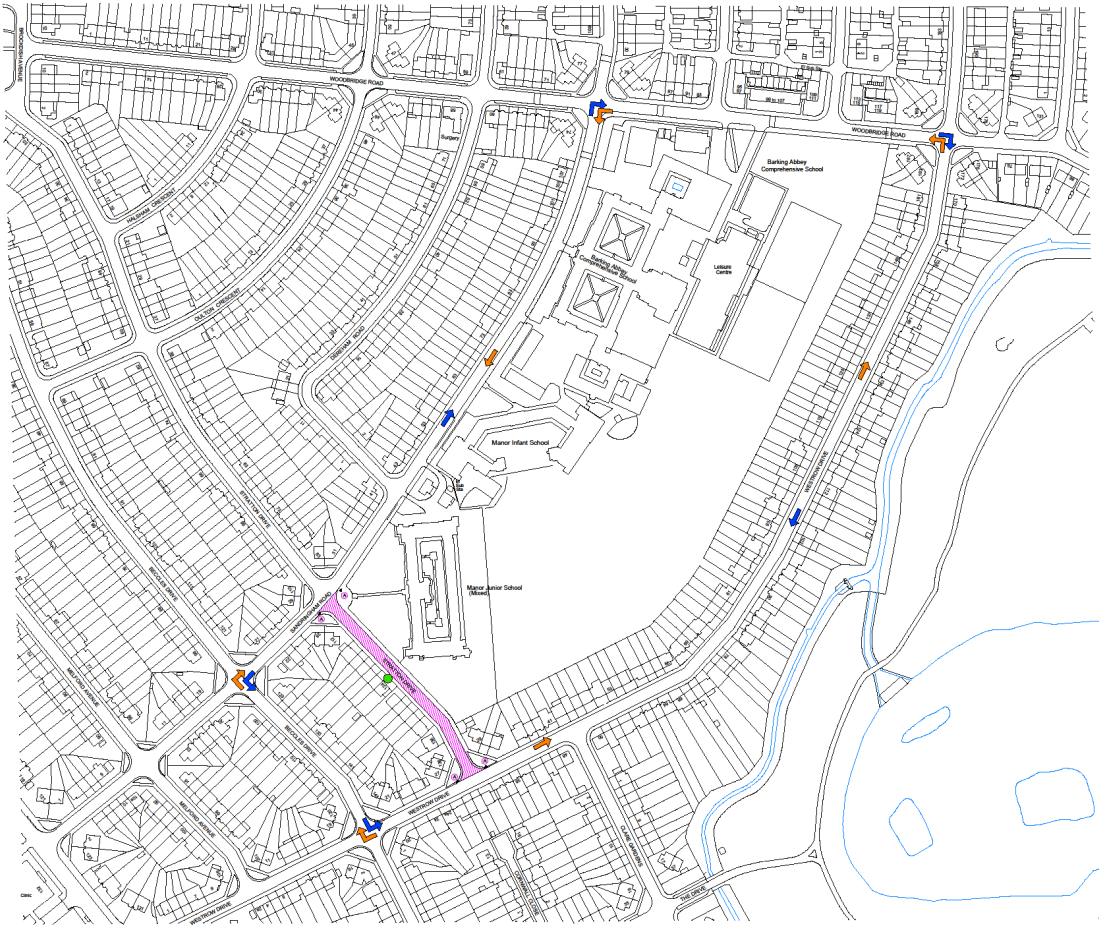

LEGEND

- Extent of Road Closure for School Streets
Closure Period: from 02/11/20 for 18 months
Closure Times: 8.00am-9.15am & 2.45pm-4.00pm
- Proposed Camera Sites
- Diversion around school closure

RECEPTION ZONE

NO MOTOR VEHICLES
8.00am - 9.15am
2.45pm - 4.00pm
Hatched green
vehicles only

Drawn: SJC Checked: []
Scale: 1 : 500 Date: September 2020
Drawing No: BFCOM-STR-22-02-CR-0201

BeFirst Traffic on behalf of the Local Council of Woking & Bagshot

Be First
Maritime House, 9th Floor
1 Linton Road
Barnhill GU11 9LD

Scheme: SCHOOL STREETS - MANOR JUNIOR SCHOOL

Title: TMO CLOSURE PLAN